

AMG350 7 PORT SERIES INDUSTRIAL UNMANAGED SWITCHES WITH OPTIONAL 30/60/90W POE

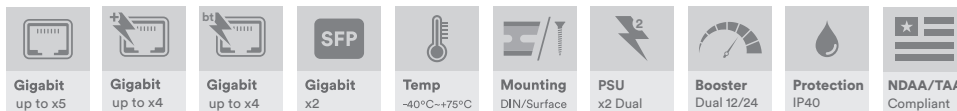

Industrial Ethernet Solutions

AMG's unmanaged Ethernet switches provide 100Mbps or Gigabit Ethernet switching for simple edge network applications with optional 30W or 60/90W PoE. Available with a combination of 5x RJ45, and 2x SFP ports for maximum system flexibility.



[AMG350 7 Port Series]

/ OVERVIEW

Designed in a compact DIN rail or wall mount housing, the AMG350 series unmanaged Ethernet switches are ideally suited for connecting edge devices to Ethernet networks where more complex management functions are not required. Long distance connections are supported using all types of fiber through the integrated SFP port(s). Fiber connectivity is determined by separate SFP device selection, providing application and site flexibility.

Available in both non-PoE models as well as PoE models for IEEE802.3at 30W or IEEE802.3bt 60/90W they are suitable for powering the latest high powered PoE devices over a wide industrial operating temperature range.

Fitted with dual redundant power inputs and power failure alarm relay ensures maximum operating reliability and the highest levels of performance.

The LV models feature a 12-56VDC booster circuit with a regulated 54VDC output to supply PoE from a low voltage power input.

SFPs and PSUs need to be ordered separately.

/ FEATURES

- Compact size – ideal for confined spaces, including camera poles and roadside cabinets
- -40°C to +75°C temperature maintains performance in extreme conditions
- Plug & Play – no need for any user configuration
- DIN rail mountable – quick to install and remove for maintenance
- All SFP ports are Gigabit only – support single and multimode, single or dual fiber options up to 120Km
- Dual redundant power inputs with fault relay
- Supports optional 15W, 30W, 60W and 90W PoE
- Auto-Negotiation (802.3u) – automatically determines the best connection speed
- Designed in the USA & UK. Manufactured in the United Kingdom
- AMG Lifetime Support Warranty

Specifications.

Standards.

IEEE802.3i	10Base-T
IEEE802.3u	100Base-TX
IEEE802.3ab	1000Base-T
IEEE802.3z	1000Base-X
IEEE802.3af	15W PoE
IEEE802.3at	30W PoE+
IEEE802.3bt	60 & 90W PoE
IEEE802.3x	Flow Control

Jumbo Frames	9Kbytes
Address Table	4K MAC Entries
Switch Fabric	14 Gbps
Buffer Memory	2M bits

Interface.

LED Indicators	2x Power SFP Link/Activity RJ45 Link/Activity PoE (PoE Models Only) Alarm Speed (Non-PoE Models Only)
RJ45 Ports	5x 10/100/1000T(X) RJ45 with Auto MDI/MDI-X with 2 kV Isolation Protection
SFP Slots	2x 1000FX SFP
Power/Relay	1x 6-way Screw Terminal

Power.

Power Inputs	2
Operating Voltage:	
Non-PoE Models	10-56V _{DC}
LV PoE Models	12-56V _{DC}
30W PoE Models	48-56V _{DC}
90W PoE Models	52-56V _{DC}
Power Consumption	4.5W Max (without PoE Load)
Total PoE Budget:	
LV PoE Models	60W (@12-23V _{DC}) 120W (@24-56V _{DC})
30W PoE Models	120W
90W PoE Models	240W
PSE Modes	Mode A (30W Ports) Mode A, Mode B (60/90W Ports)
PoE Enabled Ports Protection	Ports 1-4 (model dependent) Reverse Polarity Overload Current
Alarm Relay	Form A 24V _{DC} @ 1A Max

Packaging.

Shipping Weight:

Non-PoE, 30W & 90W PoE Models 1.01kg / 2.23lb

30W LV PoE Models 1.09kg / 2.40lb

Dimensions: (W x D x H)
260 × 200 × 60 mm
10.24 × 7.87 × 2.36 in

Mechanical.

Housing	Anodised Aluminium
Dimensions:	(W x D x H) (Excluding DIN & Wall Mounts)
Non-PoE, 30W & 90W PoE Models	47 × 106 × 144 mm 1.85 × 4.17 × 5.67 in
30W LV PoE Models	50 × 106 × 144 mm 1.97 × 4.17 × 5.67 in
IP Rating	IP40
Installation	Wall Mount or DIN-Rail
Weight:	
Non-PoE, 30W & 90W PoE Models	0.81kg / 1.79lb
30W LV PoE Models	0.89kg / 1.96lb

Environmental.

Operating Temp.	-40 to +75°C / -40 to +167°F
Storage Temp.	-40 to +85°C / -40 to +185°F
Humidity	5% to 95% (non-condensing)
MTBF	508,869 hours
MTBF Standard	Telcordia SR-332 GB 50°C
Heat Dissipation	15 BTU/h (Non-PoE) 425 BTU/h (with 120W PoE load) 834 BTU/h (with 240W PoE load)
Cooling	Passive Cooling
Noise Level	0 dBA

Regulatory.

Safety	IEC/EN 62368-1
EMI	EN 55032 Class A CISPR 32 EN55035 FCC Part 15B Class A
EMS	EN 61000-4-2 (ESD) EN 61000-4-4 (EFT) EN 61000-4-5 (Surge)
Shock	IEC 60068-2-27
Free Fall	IEC 60068-2-32
Vibration	IEC 60068-2-6
Environmental	Reach, RoHS, WEEE
Traffic	NEMA TS2
Supply Chain	NDAA & TAA Compliant

Part Numbers.

7 Port Unmanaged 1Gb Ethernet Switches

AMG350-5G-2S	5x 10/100/1000TX RJ45, 2x 1000FX SFP, 10-56VDC
AMG350-4GAT-1G-2S-P120	4x 10/100/1000TX RJ45 (4x 30W PoE, Max 120W), 1x 10/100/1000TX RJ45, 2x 1000FX SFP, 48-56VDC
AMG350-4GAT-1G-2S-P120-LV	4x 10/100/1000TX RJ45 (4x 30W PoE, Max 120W), 1x 110/100/1000TX RJ45, 2x 1000FX SFP, 12-56VDC Low Voltage Booster
AMG350-4GBT-1G-2S-P240	4x 10/100/1000TX RJ45 (4x 60/90W PoE, Max 240W), 1x 10/100/1000TX RJ45, 2x 1000FX SFP, 52-56VDC

Included Accessories.

DIN Rail Adapter

Wall Mounting Brackets

Rear Mounted Metal DIN Rail Clip & Screws For DIN Rail Mounting AMG350 Series Products

2x Wall Mounting Brackets & Screws For Wall / Surface Mounting AMG350 Series Products

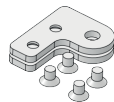
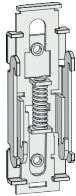

Recommended PSUs.

Non-PoE Models

AMGPSU-W12-P25

AMGPSU-I12-P24A

AMGPSU-T12-P15

Plug Top Mounting Lite Industrial Grade PSU, 0 to +70°C, 12VDC, 25W, NDAA Compliant, UK/EU/US Plug Heads Included

DIN-Rail Mount Industrial Grade PSU, -25 to +70°C, 12VDC, 24W, NDAA Compliant*

DIN-Rail Mount Industrial Grade PSU, -25 to +70°C, 12VDC, 15W, NDAA & TAA Compliant*

PoE Models

AMGPSU-I48-P120A

AMGPSU-I48-P145

AMGPSU-I48-P240A

AMGPSU-I48-P290

AMGPSU-I48-P480A

AMGPSU-I48-P530

DIN-Rail Mounting Industrial Grade PSU, -40 to +70°C, 48-55VDC, 120W, NDAA Compliant**

DIN-Rail Mounting Industrial Grade PSU, -25 to +70°C, 48-55VDC, 145W, NDAA & TAA Compliant*

DIN-Rail Mounting Industrial Grade PSU, -40 to +70°C, 48-55VDC, 240W, NDAA Compliant**

DIN-Rail Mounting Industrial Grade PSU, -25 to +70°C, 48-55VDC, 290W, NDAA & TAA Compliant*

DIN-Rail Mounting Industrial Grade PSU, -40 to +70°C, 48-55VDC, 480W, NDAA Compliant**

DIN-Rail Mounting Industrial Grade PSU, -25 to +70°C, 48-55VDC, 530W, NDAA & TAA Compliant*

* Also available in kit form including mains line cord, DC cable and DIN rail. Order with -K at the end of the part code (e.g. AMGPSU-I48-P120A-K).

^ Also available with no exposed mains terminals and direct IEC input kit. Order with -IEC at the end of the part code (e.g. AMGPSU-I48-P120A-IEC).

Optional Accessories.

AMGMNT-MAG-04

AMG2035

SFP Modules

4x Rear Mounted Magnets & Screws Kit For AMG350 Series, need to be ordered separately

Side Mounted Wall Bracket Adapter Kit For DIN Rail Mounting AMG350 Series Products In Depth Restricted Installations.

Adapter Kit Can Be Extended Using The Included Extension Kit To Also Mount A DIN Rail Power Supply Up To 480W

1Gb Optical/Copper Modules see separate list, need to be ordered separately

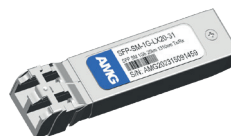
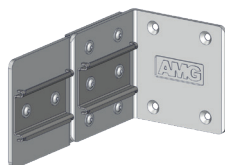
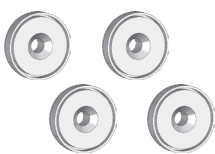

In a continuing effort to improve and advance technology, product specifications are subject to change without notice. Please visit www.amgsystems.com for the latest product specifications.

Proud to be a UK & USA
Manufacturer 

AMG Systems Ltd. 4 Pioneer Way, Castleford, WF10 5QU, UK T: +44 (0) 1767 600 777 E: sales@amgsystems.com

AMG Systems Inc. 62 Spring Hill Road, Trumbull, CT 06611, USA T: +1-855-AMGPOE1 (855-264-7631) E: sales@amgsystems.com

D33900-03

amgsystems.com

AMG